

DETAILED PARTS AND ASSEMBLY PROCEDURE

No.	Part No.	Description	Available Kits & Component Parts		
			1250RO-2	1250RO-3	1250RO-4
1	OL unit	Pulsarlube OL	Sold separately		
2	A002	Reducer, 3/8"F X 1/8"M Adaptor		1 ea	
3	B002	Mounting Bracket, "L"Shape		1 ea	
4	B057	Washer		1 ea	
5	B051	Self Drilling Screw, #8 x 20	7ea	9ea	11ea
6	C006	Reducer, PT 1/8"F X M8 X 1P		1 ea	
7	C003-1	Distributor, 3(1P) M8 x 1P	1ea	-	-
8	C003-2	Distributor, 4(2P) M8 x 1P	-	1 ea	-
9	C003-3	Distributor, 5(3P) M8 x 1P	-	-	1 ea
10	C004	Resistance Valve, #1 Distributor Spray	2ea	3ea	4ea
11	C021-2	Distribution Tubing, O.D. 4mm x I.D. 2.5mm Nylon Tubing, 20ft (6m)	1ea	-	-
12	C021-3	Distribution Tubing, O.D. 4mm x I.D. 2.5mm Nylon Tubing, 30ft (9m)	-	1 ea	-
13	C021-4	Distribution Tubing, O.D. 4mm x I.D. 2.5mm Nylon Tubing, 40ft (12m)	-	-	1 ea
14	C010	Tube Clamp, Dia. 4mm x 1R	4ea	6ea	8ea
15	C007	Tube Fitting, Dia. 4mm x PT1/8"M	2ea	3ea	4ea
16	C011	Insert, Dia. 4mm x 2.5mm	2ea	3ea	4ea
17	C009	Sleeve Ring, Dia. 4mm	2ea	3ea	4ea
18	Cable Tie		4ea	6ea	8ea

NOTE : Oil brush and bracket assembly is available (sold separately).

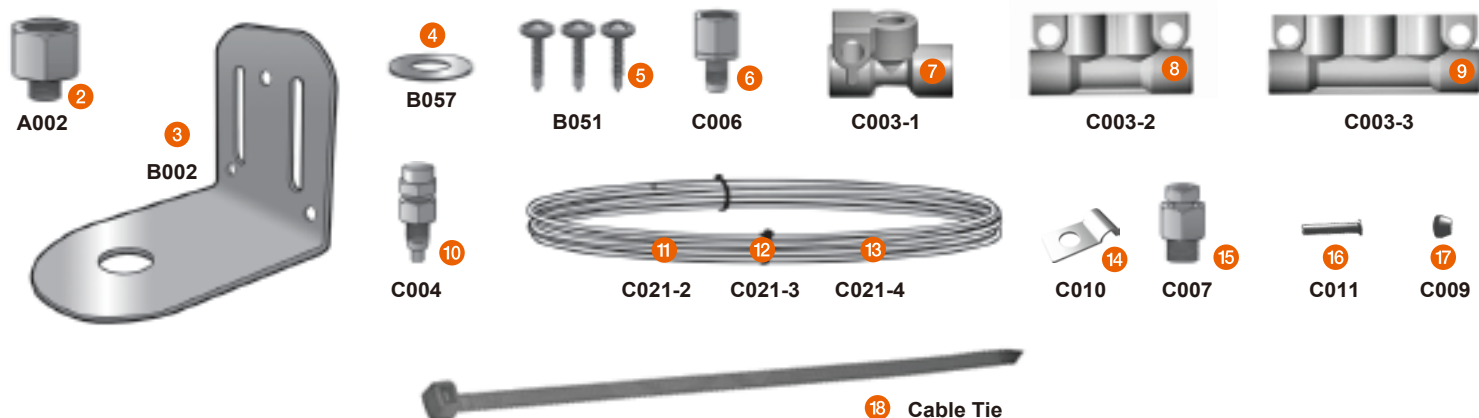

DETAILED PARTS AND ASSEMBLY PROCEDURE

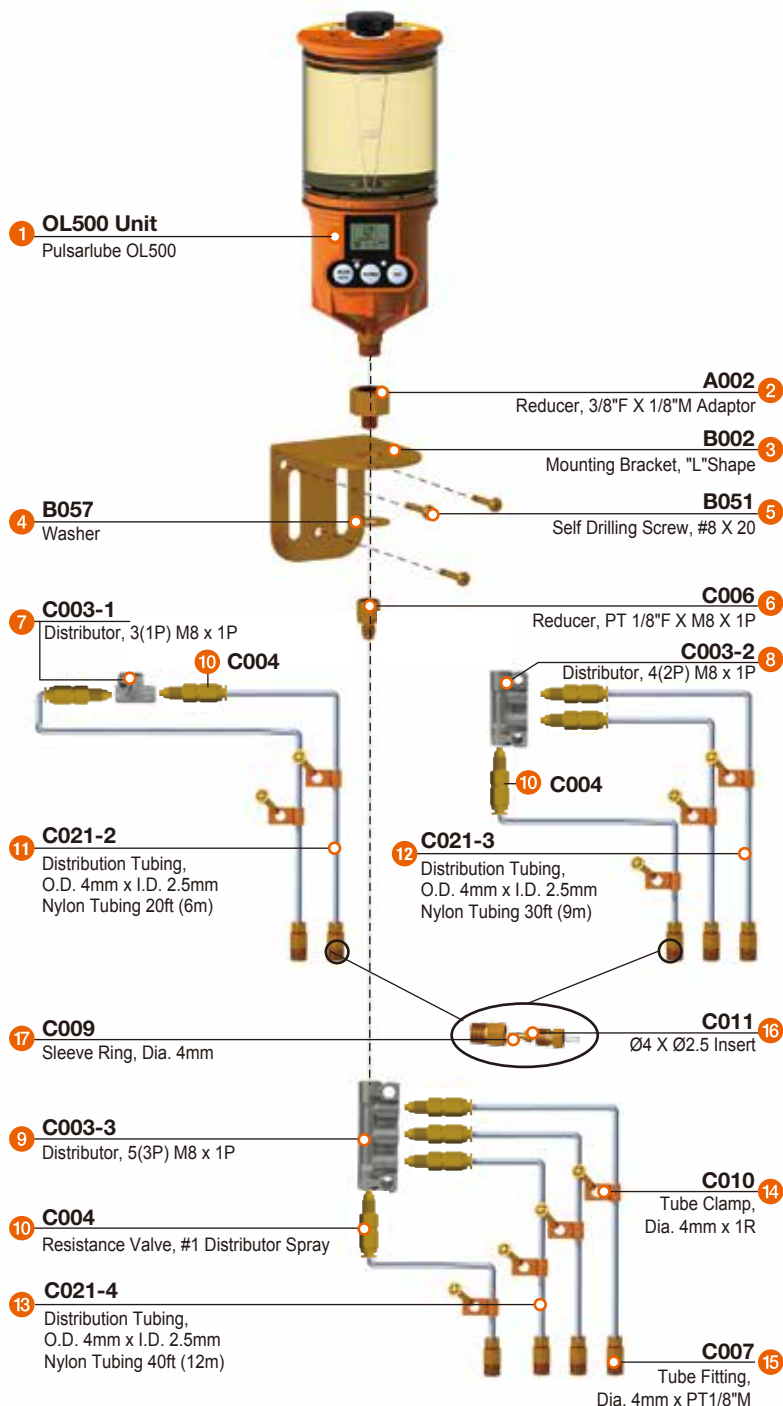

ASSEMBLY PROCEDURE

1. Install the mounting bracket (3) at a proper location using screws (5) to allow for easy installation and filling of oil.
2. Install the lubricator using the reducer (2), washer (4), and reducer (6).
3. Remove the oil reservoir lid and fill the cartridge with oil to the 500ml level on the label. Turn the hand knob counter clockwise 1~2 turns before closing the lid to open the vent and relieve vacuum pressure.
4. Press the "TEST" button for 2 seconds to run test mode. Confirm that the unit is dispensing oil properly.
5. Assemble the reducer (6) and the fitting connector (7).
6. Connect one end of the tubing to the resistance valve (10) and the other end of the tubing to the fitting connector (15). Assemble the insert (16) and sleeve ring (17) in order, as shown in the circled image on the left.
(If an oil brush and bracket assembly is to be used, connect tube brush to a fitting connector (15) at the end of lube line using an appropriate socket.)
7. Use the tube clamps (14) and screws (5) to affix the tubing (11) to a wall.
8. Install lubricator and follow lubricator operation instructions on user manual.

COMMENTS

Apply PTFE Tape around the thread on fittings (2) and (15) and on the tip of the lubricator.
Do not use PTFE Tape on parts (6), (10), or (11).

Output volume may vary depending on oil viscosity, length of lube line, ambient temperature, etc.

NOTE : All parts above are Metric thread.

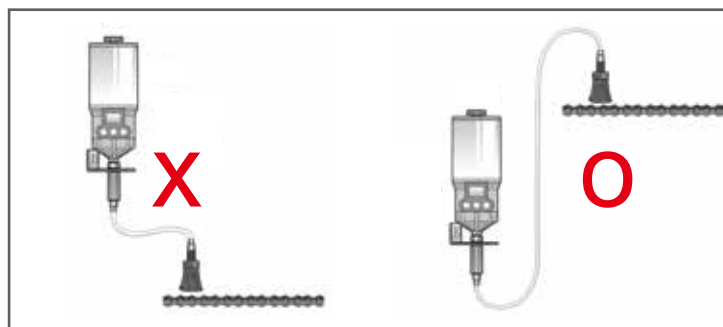

Warning

For oils below ISO VG 100, place the oilers below the lube points and twist the lube lines a couple of times to avoid oil leaks caused by gravity.

For oils below ISO VG 100 – OL500 products should be installed below the lube points.