

详细零部件&组装步骤

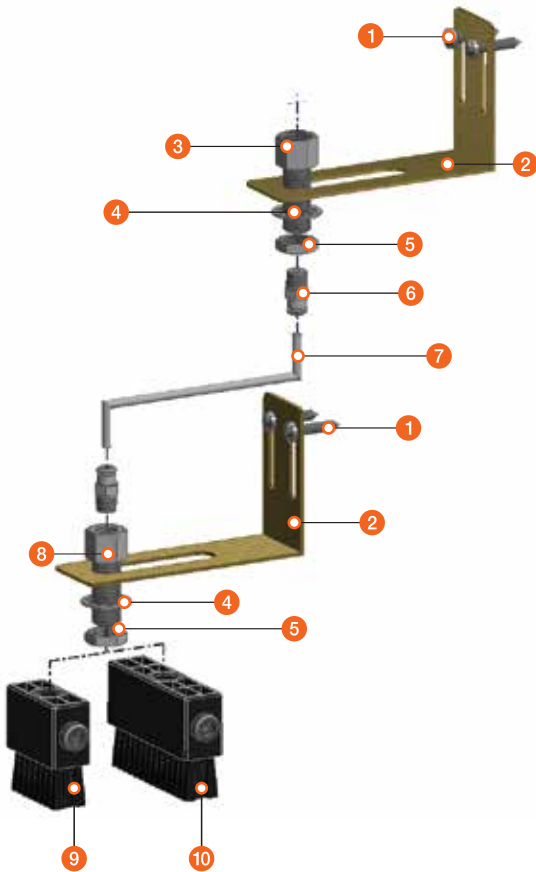

| LIST | PART No. | DESCRIPTION | Q'TY |
|------|----------|---|------|
| ① | B051 | Self Drilling Screw, #8 x 19, Steel | 4 |
| ② | B003-01 | Oil Brush Bracket, "L" Shape, Steel | 2 |
| ③ | A315 | Reducer, PT3/8" F x PF1/4" Mx30mm x PT1/8" F, Steel | 1 |
| ④ | B058 | Tooth Washer, O.D.23mm x I.D.14.5mm x 1t, Steel | 2 |
| ⑤ | N001 | Nut, PF1/4" F x 5mm, Steel | 2 |
| ⑥ | A317 | One-Touch fitting, Ø4 x PT1/8" M, Nickel Plated | 2 |
| ⑦ | C021-1 | Nylon Tube, 3m (10ft) O.D. 4mm x I.D. 2.5mm | 1 |
| ⑧ | A316 | Reducer, PT1/8" F x PF1/4" M x 25mm Adaptor, Steel | 1 |
| ⑨ | C017 | Oil Brush, 45 x 20 x 30mm Flat Nylon, PF1/4" F | 1 |
| ⑩ | C018 | Oil Brush, 74 x 20 x 30mm Flat Nylon, PF1/4" F | 1 |

组装步骤

1. 安装油刷支架 (②) 使用自攻螺丝钉固定在合适的位置 (①).
 2. 插入接头 (③), 垫圈 (④), 螺母 (⑤) 快插式接头 (⑥).
 3. 安装另一个油刷支架 (②) 使用自攻螺丝钉固定在合适的位置 (①) 远程安装.
 4. 固定牙垫圈 (④), 螺母 (⑤), 接头 (⑧) 快插式接头 (⑥).
- 连接尼龙管的两端 (⑦) 连接两端快插式接头 (⑥).
5. 连接适当的油刷 (⑨) 或 (⑩) 到异径接头 (⑧).

注释

排量因油粘度, 环境或温度等有所不同

| LIST & PART No. | KIT No. | DESCRIPTION |
|----------------------|-------------|---|
| [① ~ ⑧] + ⑨ (C017) | C046 | [OL] Remote Installation & 45mm Oil Brush Kit |
| [① ~ ⑧] + ⑩ (C018) | C047 | [OL] Remote Installation & 74mm Oil Brush Kit |